

## Technical Information

The Predator ED63900 is a true Deep Cycle Absorbent Glass Mat (AGM) battery.

The grids and active material are manufactured using 99.99% virgin lead to ensure maximum performance & durability. A unique double separator configuration delivers high energy density and excellent vibration resistance.

The valve regulated, non-spillable design delivers outstanding cycle life and a low self discharge rate for longer shelf life.

This battery can be used in all Industrial and Heavy Duty applications where a 6 Volt battery is required.

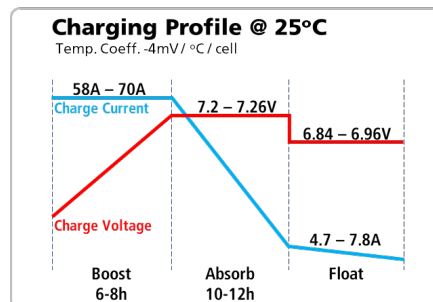
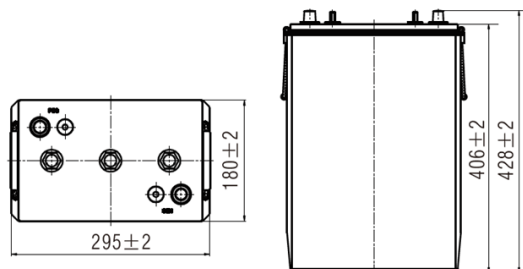

## Features & Benefits

- True Deep Cycle AGM technology
- Heavy Duty, Non-Spillable Design
- Double Separator Construction
- High Energy Density & Cycle Life
- Low Self Discharge

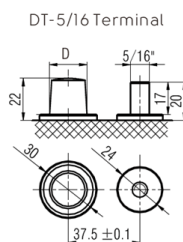

## Cycle Life vs Depth of Discharge (DoD)

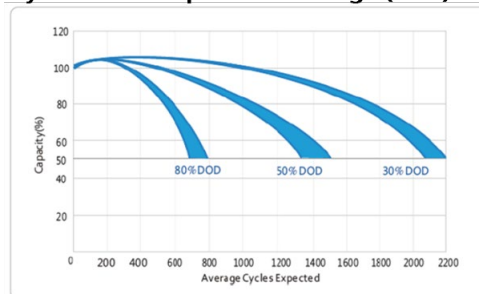

## Technical Specifications

<b>Battery Type</b>	Deep Cycle AGM	<b>Case Material / Colour</b>	Polypropylene / Black
<b>Voltage</b>	6V	<b>Lid Type / Colour</b>	VRLA / Black
<b>Capacity (20Hr / 5Hr)</b>	390Ah / 331Ah	<b>Plate Type</b>	AGM Cast Grids
<b>Reserve Capacity (25A)</b>	915 minutes	<b>Separator Type</b>	Glass Mat
<b>Reserve Capacity (75A)</b>	255 minutes	<b>Assembly Layout</b>	Diagonal
		<b>Terminal Type</b>	Dual (SAE taper & 5/16")
<b>Overall Size (LxWxH)</b>	295 x 180 x 428mm	<b>Case Size</b>	BCI Grp 903
<b>Nominal Weight</b>	54.2kg	<b>Ledges</b>	None